

← Space →
is $99\frac{3}{4}$ "

Bottom of desk installed
 $27\frac{1}{2}$ " off floor. Top of
desk at 29 "
off floor.

WEST WALL

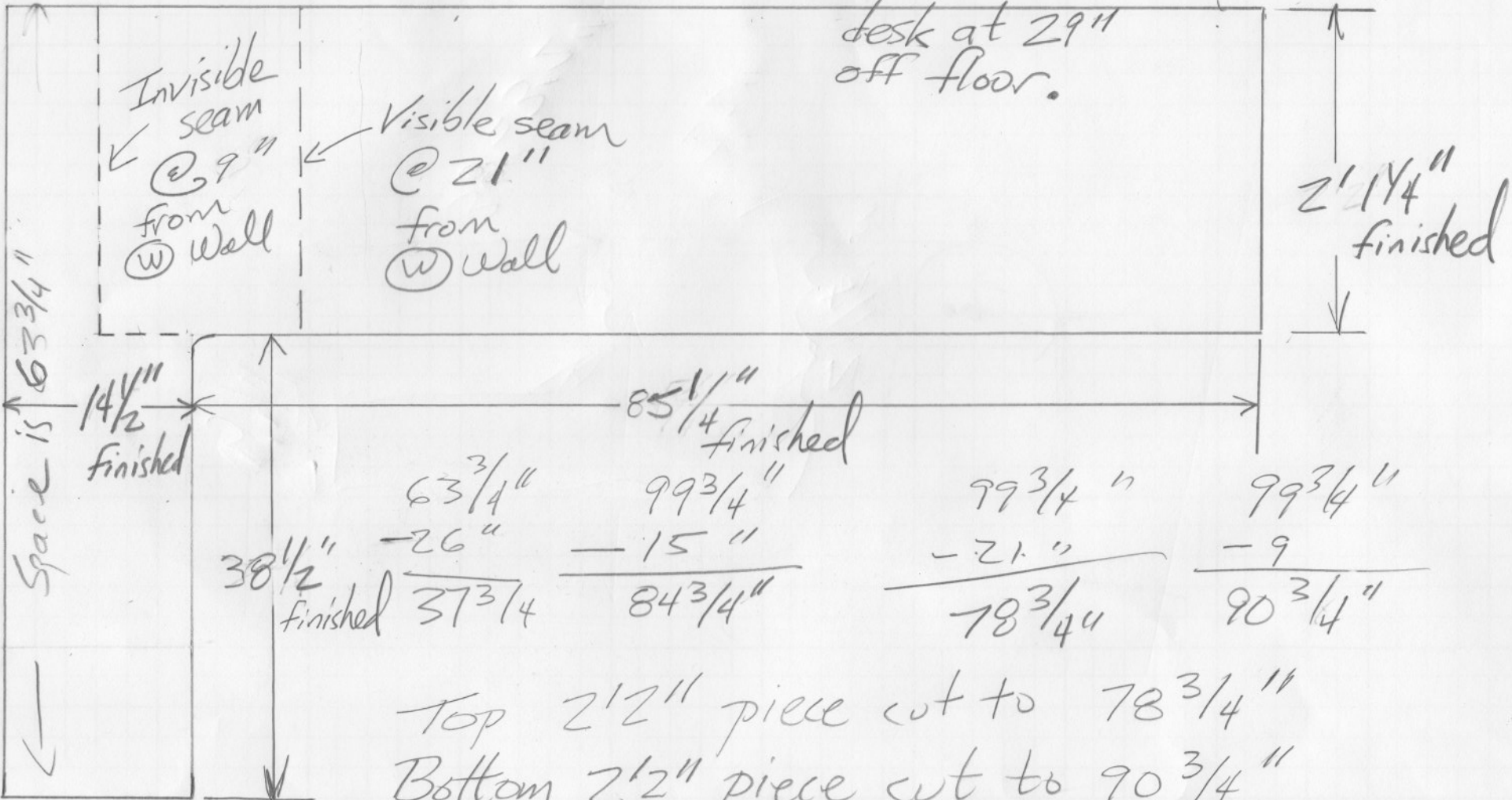

Top $2'2$ " piece cut to $78\frac{3}{4}$ "

Bottom $2'2$ " piece cut to $90\frac{3}{4}$ "

Top L has >21 " width
Bottom L has >9 " width