

Perkins eliminated during construction - 5/8" plywood for roof deck

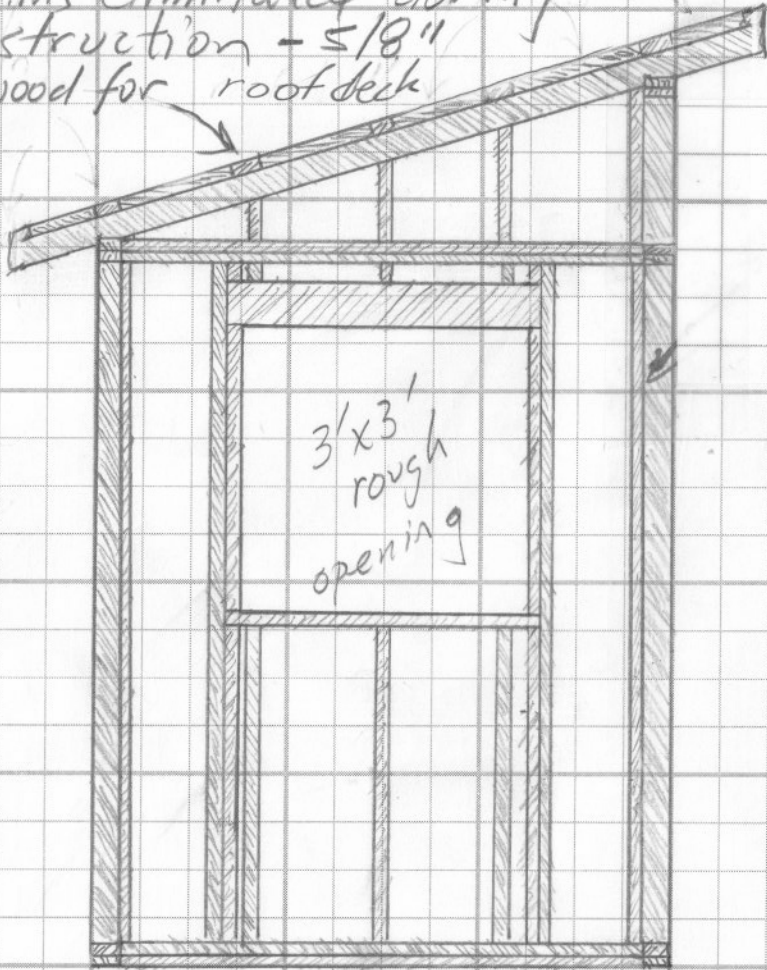

East
(and West)
wall framing
plans

* 9 2x4's
* 3 6' top and bottom plates
39" headers

California corners
of 4x4's.
instead

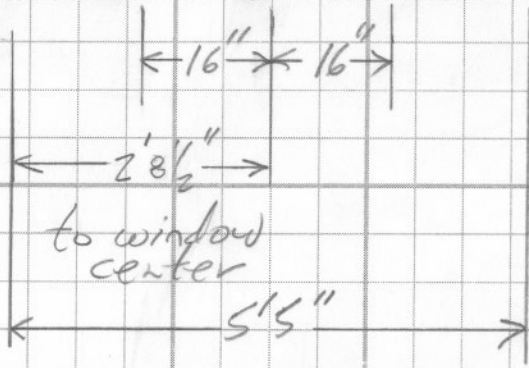
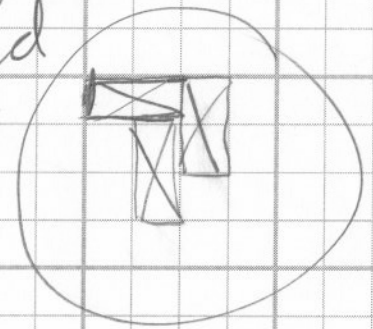

Drawn with 4:12
pitch - ? -
better at 3:12?

← eventually chose 3.5:12
↑
great choice!



East wall
framing plan -

3' x 3' window not

the south wall cannot be made lower

South Wall framing plan

Requirements for south wall:

- * 6 king-length 2x4's
- * 2 king-length 4x4's
- * 2 jack-length 2x4's
- * 3 9' top and bottom plates
- * 1 3 1/4" header

$$82" + 5\frac{1}{2}" - 2 \times 1\frac{1}{2}" = 84\frac{1}{2}"$$

34 1/4" x 82" rough opening

$$90\frac{1}{2}" = 84\frac{1}{2}" + 4 \times 1\frac{1}{2}"$$

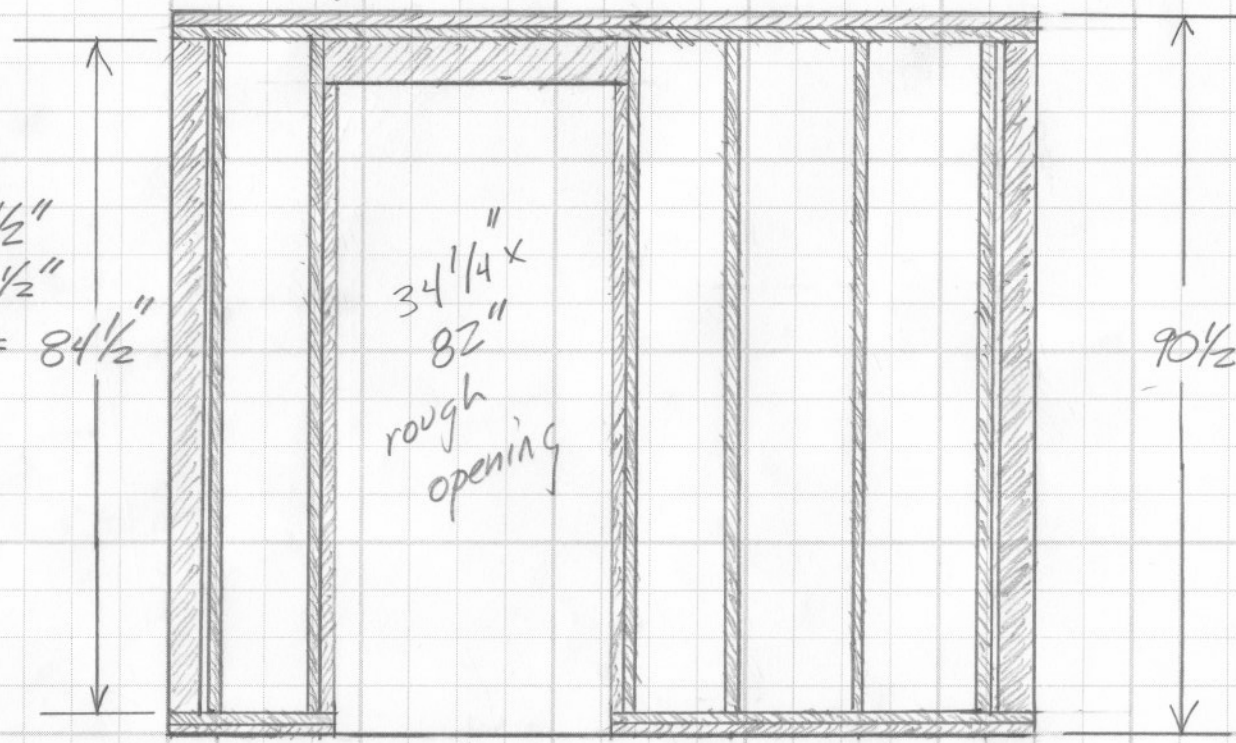

6" to door center
3'2"

16" * 16" * 6"
stud centers

North wall framing plan

- * 11 studs
- * 2 4x4's
- * 3 9' top and bottom plates
- * 1 51" header
- * 1 48" rough sill

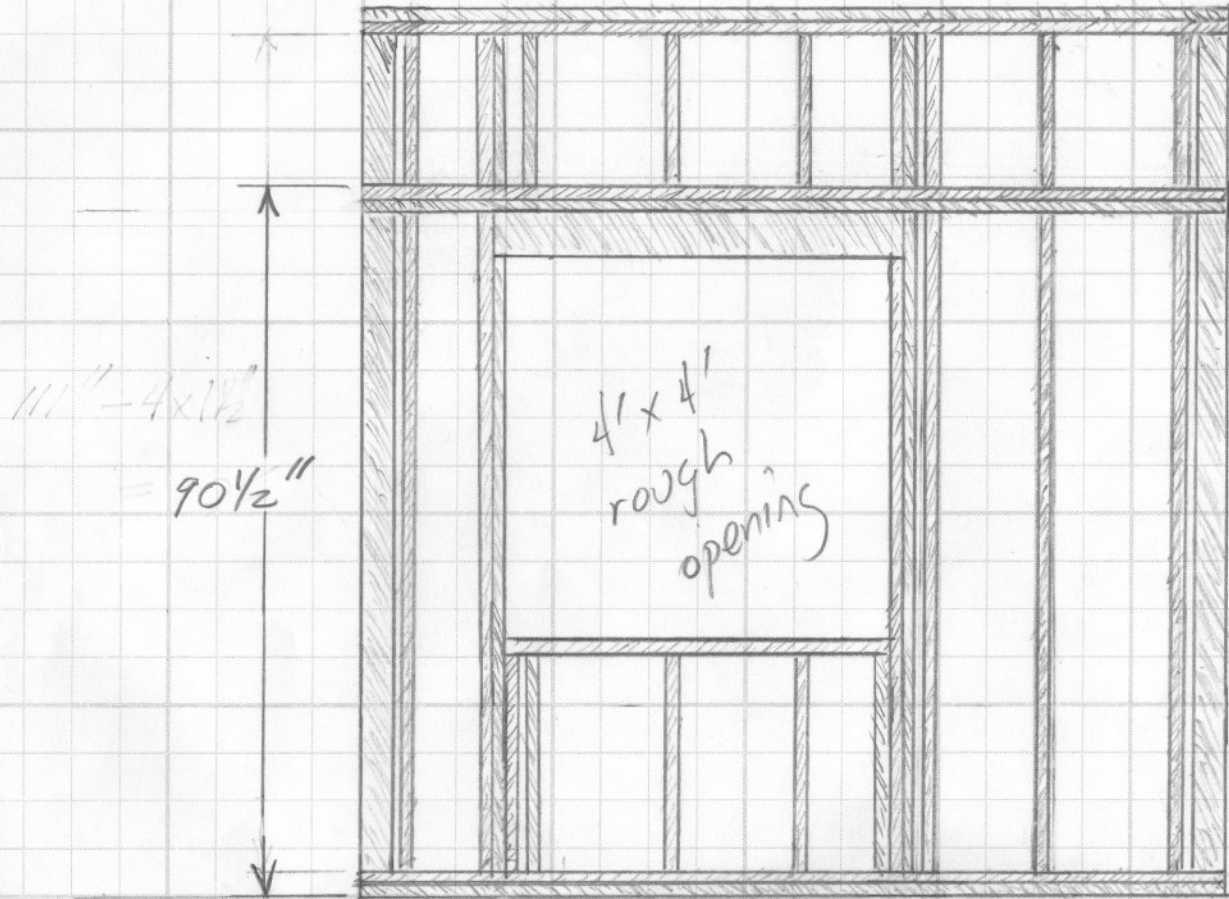

King studs
are
84 1/2"

Window jack
studs are
77"

Side window
jack studs are
73"

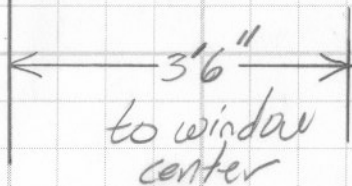
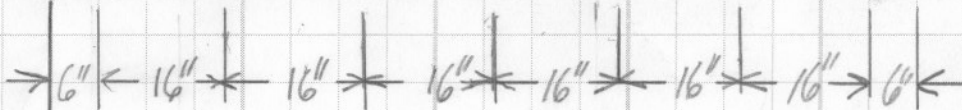

Cripple wall
corner detail

